

MicroAir Description and Mounting Instructions

Ultra Low Air Pressure Regulators and Controllers

On Line Controls, Inc.
www.onlinecontrols.com

DESCRIPTION

- Hysteresis free control action
- Stainless steel enclosure
- Precision output pressure display (4 ½" magnehelic meter) (accurate to 2% of scale)
- Stainless steel plumbing and valve
- Viscostatic Damping to ensure stability - oil supplied with unit.
- Stability and precision down to 10% of full scale.
- Air Output –

Range	Max Output Flow Rate
5 inch wc	11 SCFH
15 inch wc	25 SCFH
30 inch wc	40 SCFH
3 psi	70 SCFH
5 psi	90 SCFH

Other ranges available upon request.

0 – 5 psi Maximum, 0 – 2 inch wc minimum.

Note: Inch wc = inch of water column

SCFH = Standard Cubic Feet per hour

1 psi = 27.68 inch wc

MicroAir I

- Manual Model – no electronics, no options.
- Simple one knob (30 turn) adjustment.
- Dual and 3-channel MicroAir I units available.

MicroAir II

- Connects to OD gauge control outputs / accepts contact closure inputs.
- Up & Down manual control push buttons and limit indicator.
- Motorized Up/down remote control, accepts solid state or mechanical relays. Internal screw terminals Up/Down/Ground.
- Dual selectable voltage input 110/220 volt 50/60 Hz. 3 conductor grounded IDC power cord supplied.
- Zero to Full Scale in approximately 2 minutes.
- Dual and 3-channel MicroAir II units available.

MicroAir IV (for bump tubing)

- Ultra high speed operation.
- 10 turn manual control.
- 0-10 volt control input connects to any controller with programmable DC output.
- For dual state, set Hi and Lo low pressure points with front knobs.
- Repeatability of better than 1% of full scale.
- Response time of less than one tenth of a second for steps of 50% of full scale (typically 20-30 msec).

- Control inputs – terminal strip +/-
- Control mode: Dual State or Linear.
- Dual selectable voltage input 110/220 volt 50/60 Hz. 3 conductor grounded IDC power cord supplied.
- Dual, 3-channel and 4-channel MicroAir IV units available.

MOUNTING INSTRUCTIONS for single channel units

- Vertical mounting is essential.
- Four 5/16" diameter holes will accommodate both ¼ and 5/16 mounting bolts.
- Locate close to Die with ¼ NPT male fitting.
- Left side air in and right side air out (keep clear).
- Recommend quick disconnect fitting.
- Air connections – plant air regulated down to 45 psi (+/- 10 psi).
- Maximum Air Input flow required not to exceed 2.5 SCFM per channel (150 SCFH).

Width	10 in (25.4 cm)
Height	12 in (30.5 cm)
Depth	6 in (15.2 cm)

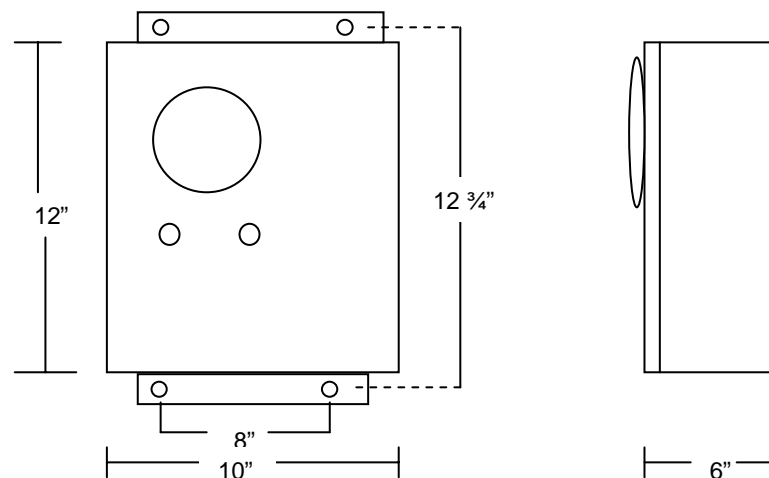

Options for MicroAir II and IV

Digital Display LED 0.1 inch wc resolution

Two decimal points available on units 0-10 inch wc or less.

4-20 ma output – current output

1-6 volt output – voltage output

On Line Controls, Inc.
9A Kane Industrial Dr.
Hudson, MA 01749-2905

Tel: 978-562-5353
Fax: 978-562-8986
olc@onlinecontrols.com